

OFFICIAL ZONING MAP CITY OF HORACE SEPTEMBER 19, 2016

PROPOSED DIVERSION DITCH

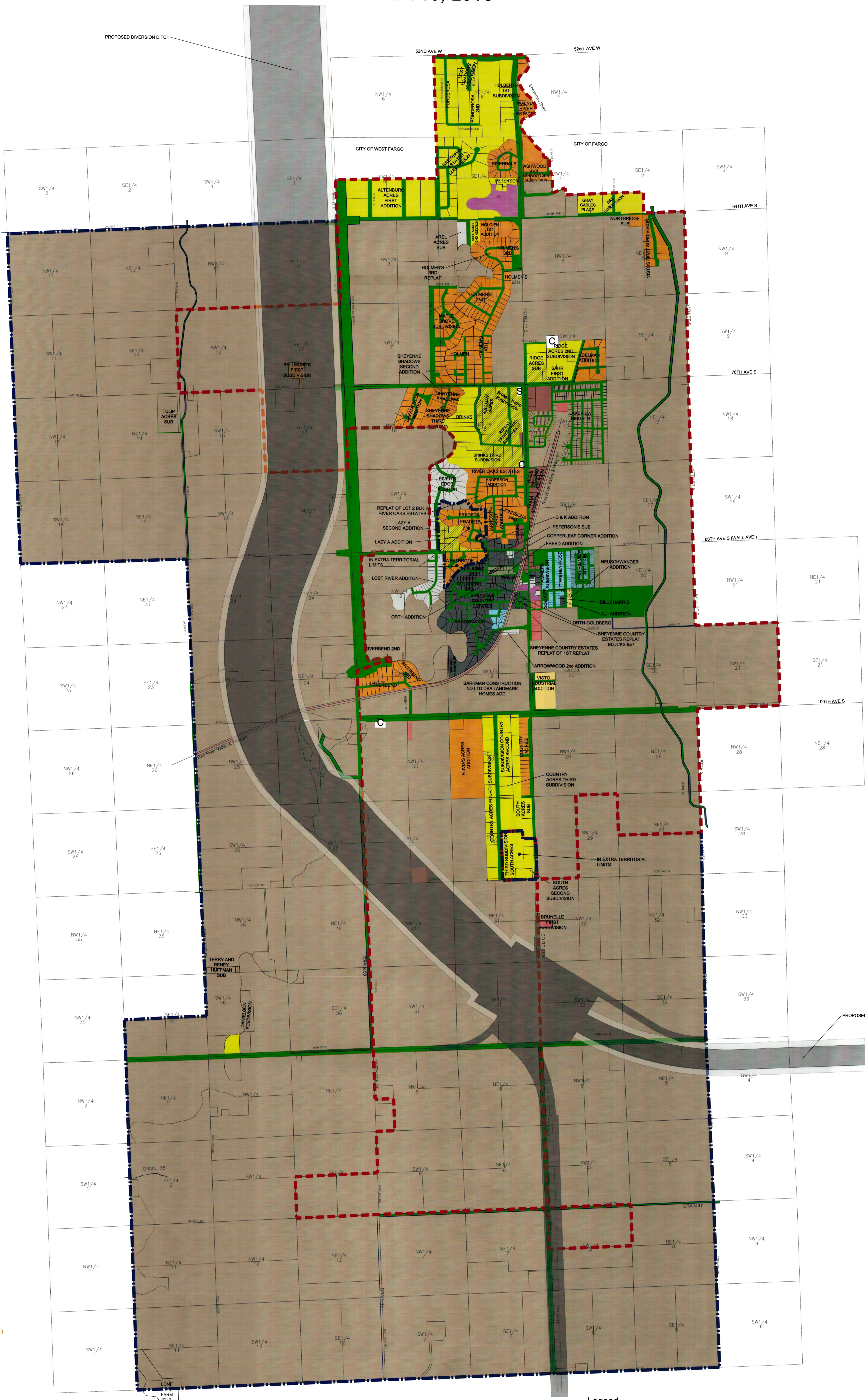



Legend for Additions & Subdivisions

- ADELMAN ACRES 2014-09-8 (SR)
- ADELMAN ADDITION 2015-02-17 (R-E)
- A.J. ADDITION 1999-11-02 (R1)
- ALVIA'S ACRES ADDITION 2016 (R-E)
- ALTEMBURG ACRES FIRST SUBDIVISION 1996-05-13 (SR)
- ANDERSON ADDITION 2004-06-21 (SR)
- AREL ACRES SUBDIVISION 1994-05-11
- AREL ACRES 2ND ADDITION 2014-05-12 (SR)
- ARNESON FIRST ADDITION 1988-03-04 (R-E)
- ARROWWOOD 2002-09-27 (R1, R4) and (R5)
- ARROWWOOD 2nd ADDITION 2015-06-15
- ASHWOOD SUBDIVISION 1993-07-26 (R-E)
- ASHWOOD 3RD SUBDIVISION 2002-09-20 (R-E)
- BARK MAN CONSTRUCTION ND LTD DBA LANDMARK HOMES ADD 2005-07-28 (R4)
- BELLMORE'S FIRST SUBDIVISION 1997-03-12 (R-E)
- BILLY HARRIS ADDITION 1993-10-04 (R4)
- BRC SUBDIVISION 1998-10-28 (SR)
- BRINKS SUBDIVISION 1984-07-19 (SR)
- BRINKS SECOND SUBDIVISION 1992-02-18 (SR)
- BRINKS THIRD SUBDIVISION 1996-07-15 (C3)
- BRINKS THIRD SUBDIVISION REPLAT LOT 3 BLOCK 1 LOT 6 BLOCK 2 1997-03-11 (C3)
- BRUNELLE FIRST SUBDIVISION 2001-11-20 (C3)
- COPPERLEAF CORNER ADDITION 2015-10-13 (SR)
- COUNTRY ACRES SUBDIVISION 1977-07-18 (SR)
- COUNTRY ACRES SECOND SUBDIVISION 1997-04-09 (SR)
- COUNTRY ACRES THIRD SUBDIVISION 1998-07-28 (SR)
- COUNTRY ACRES FOURTH SUBDIVISION 2001-12-06 (SR)
- D & K ADDITION 2006-05-08 (R1)
- DANIELSON SUBDIVISION 2004-01-07 (A)
- DREAMFIELDS ADDITION 2014-03-31 (R-E)
- FRADETS SUBDIVISION 1973-06-28 (R-E)
- FREED ADDITION 2013-10-25 (R3)
- GARLAND SUBDIVISION 2003-05-07 (R1)
- GOERGER ADDITION 1980-08-07 (R4)
- GRAY GABLES PLACE 1984-10-17 (SR)
- GREYHAWK ESTATES SUBDIVISION 1998-08-14 (SR)
- HAMMERS SUBDIVISION 1959-12-16 (C1, C3), (R1) and (R4)
- HOLMENS SUBDIVISION 1972-10-02 (R-E)
- HOLMENS 2ND 1975-10-17 (R-E)
- HOLMENS 3RD 1977-04-14 (R-E)
- HOLMENS 3RD REPLAT 1991-08-23 (R-E)
- HOLMENS 4TH 1979-10-23 (R-E)
- HOLMENS 5TH 2007-08-08 (R-E)
- HOLOEN 1ST ADDITION 2012-06-26 (RE)
- HULBERTS 1ST SUBDIVISION 2003-05-13 (SR)
- JOHNSONS 1ST 1979-03-27 (C1)
- JOHNSONS 2ND 1982-09-24 (R-E)
- LAKEVIEW HEIGHTS 2005-10-12 (SR)
- LAZY A ADDITION 2008-11-03 (R-E)
- LAZY A SECOND ADDITION 2009-10-19 (RE)
- LONE OAK FARM SUB 2013-02-27 (A)
- LOST MEADOWS SUBDIVISION 1998-05-20 (SR)
- LOST RIVER ADDITION 2016 (R2)
- MAPLE GROVE SUBDIVISION 2001-10-11 (R-E)
- NEUSCHWANDER ADDITION 2006-09-20 (H)
- NELSON 1963-10-28 (R3)
- NELSONS 2ND 1971-09-30 (R1)
- NORTHBRIDGE SUB 1990-12-28 (R-E)
- ORTH ADDITION 1993-08-10 (R1)
- ORTH-GOLDBERG 1977-09-21 (R1)
- ORTH-GOLDBERG 2ND 1979-07-02 (R1)
- PETERSON 1992-11-09 (R1)
- PETERSON'S SUB 1975-05-16 (R1)
- PONDEROSA 1982-09-24 (SR)
- PONDEROSA 2ND 1990-05-21 (SR)
- PRAIRIE WAY ADDITION 2014-10-07 VACATED (R6)
- PRAIRIE VIEW ADDITION 2015-06-01 (R6)
- RIVER OAKS ESTATES 2000-04-13 (R-E)
- RIVER OAKS ESTATES REPLAT OF LOT 2 BLK 3 2005-09-14 (R-E)
- RIDGE ACRES SUB 1994-08-26 (SR)
- RIDGE ACRES 2ND SUBDIVISION 2000-08-01 (SR)
- RIVERBEND 1976-06-14 (R-E)
- RIVERBEND 2ND 1992-06-18 (R-E)
- RIVERBEND 3RD 1995-10-05 (R-E)
- RIVERDALE 1977-08-03 (R-E)
- RIVER'S EDGE ADDITION 2015-01-22 (R2)
- RUIDS ADDITION 1999-07-09 (C1)
- RUIDS SECOND ADDITION 2005-06-24 (C1)
- SAHR FIRST ADDITION 2006-09-19 (SR)
- SOUTH ACRES SUB 1995-06-23 (SR)
- SOUTH ACRES SECOND SUBDIVISION 1998-07-23 (SR)
- SOUTH ACRES THIRD SUBDIVISION 2003-06-20 (SR)
- SHEYENNE COUNTRY ESTATES 1975-06-11 (R1)
- SHEYENNE COUNTRY ESTATES REPLAT BLOCKS 6&7 1980-07-25 (R1)
- SHEYENNE COUNTRY ESTATES REPLAT OF 1ST REPLAT 1985-10-23 (R1)
- SHEYENNE SHADOWS 1978-11-15 (R-E)
- SHEYENNE SHADOWS SECOND ADDITION 2007-12-03 (R-E)
- SHEYENNE SHADOWS THIRD ADDITION 2012-05-29 (R-E)
- TERRY AND RENEY HUFFMAN SUB 1995-06-21 (A)
- TIFFENY-ROSE 1988-06-14 (R4)
- TULIP ACRES SUB 2010-03-04 (A)
- VISTOS FIRST SUBDIVISION 2002-07-12 (R-E)
- VISTOS INDUSTRIAL ADDITION (H)
- WALLA 1965-12-03 (R1)
- WALNUT RIVER ESTATES 2009-02-10 (R-E)
- WESTBROOK 1976-12-30 (R-E)

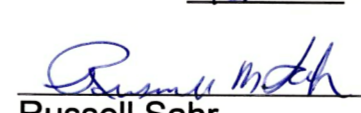
I do hereby certify that the City Planning Commission has recommended adoption of the Zoning Map by the Horace City Council.

Dated this 19th day of September, 2016

 Russell Sahr President

I do hereby certify that this Zoning Map was adopted by the Horace City Council.

Dated this 19th day of September, 2016

 Kory Peterson Mayor

 Vance Kemmer City Auditor

THE ORIGINAL SIGNED ZONING MAP IS ON RECORD AT THE CITY AUDITOR'S OFFICE.

- ### Legend
- A Agricultural District
 - S-R Suburban Residential District
 - R-E Residential Estate District
 - R-1 Single-Family Residential District
 - R-2 Single-Family Residential District
 - R-3 Medium Density Residential District
 - R-4 Intermediate Density Residential District
 - R-5 Multiple Family Residential District
 - R-6 High Density Residential District
 - MH Mobile Home (Manufactured Home) Residential District
 - C-1 Neighborhood Commercial District
 - C-2 Town Center Commercial District
 - C-3 General Commercial District
 - I-1 Light Industrial District
 - I-2 General Industrial District
 - PUD Planned Unit Development Overlay District
 - FP Flood Plain District
 - PF Public Facilities District
 - Government
 - Animal Units Apply January 2011 Zoning Map
 - C Cemetery
 - S Substation
 - City Limits
 - Extra Territorial Limits

Name:
 NAD 1983 State Plane North Dakota South FIPS 3302 Feet
 Projection:
 Lambert Conformal Conic
 Datum:
 D North American 1983
 Units:
 Foot US

